

DATASHEET

PAN SPEAKER P 04-R - PASSIVE COLUMN SPEAKER



The **Pan Speaker P04-R** is a passive speaker mounted in an attractive compact design which is suitable for speech and music applications. The loudspeaker is equipped with four 3,5" low frequency drivers content in a closed aluminum housing. The housing can be delivered in all RAL colors on customer's request. The chassis are protected against external influences by a perforated metal sheet. At the back and sides of the **P04-R** there are nuts with adjustable slot nuts which enable wall mounts and brackets. **The P04-R** can be used individually or in combination with the PS-208 Subwoofer.

Unlike Pi, the R version is equipped with two NL4 connectors and a switch. The switch allows the speaker to operate either on NL4 1+/- or 2+/-.

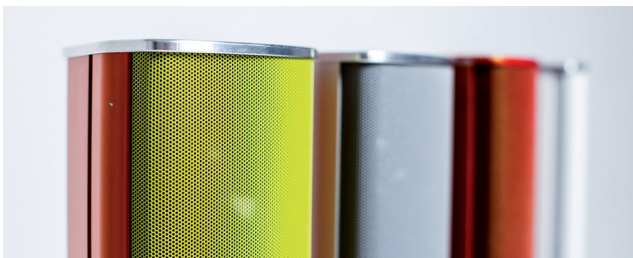

FEATURES

High efficiency, integrated protection circuits, high speech intelligibility even in the most adverse acoustic environments, sleek and unobtrusive design

For the **Pan Speaker series** there is a wide range of mounting accessories for fixed installations and mobile applications.

ADDITIONAL OPTIONS

- RAL Colour Option
(Standard color: Aluminum RAL 9006)

All **Pan Speakers** are developed, designed and manufactured by Pan Acoustics which uses high quality materials according to the stringent criteria.

MADE IN GERMANY

APPLICATIONS

Churches, Mosque, Museum, Live Sound, Train stations, Airports, Sports grounds, Parliament Conference rooms, Auditorium, Shopping center, A/V Installations

TECHNICAL DATA PAN SPEAKER P 04-R

ACOUSTIC SPECIFICATION

Type	passive column speaker
Frequency response:	150 Hz - 17 kHz (+3/-10 dB)*
Drivers:	4 x 3,5"
Rated Power:	300 W (peak _{20ms}) / 200 W (program) / 120 W (nominal)
Recommended amplifier:	Lab. Gruppen Lycia-Serie or IPD 1200
Sensitivity:	92 dB 1W/1m
Maximum SPL:	126* dB @1m
Nominal Impedance:	16 Ohm
Dispersion	
horizontal:	100° (3 kHz), 60° (10 kHz)
vertical:	30°
Connectors:	2 x NL4 + signal switch (1 +/1- oder 2+/2-)
Temperature range:	-10°C - +50°C Enviroment

*anechoic halfspace conditions

GENERAL SPECIFICATION

Enclosure:	Aluminium-Profil
Grille:	Powder coated perforated steel
Colour:	Aluminium RAL 9006
Dimensions (HxWxD):	454 x 112 x 103 mm
Weight:	1,9 kg

TECHNICAL DRAWING PAN SPEAKER 01-PI, 02-PI, 04-PI/R, 08-PI/R, 8-15-PI/R

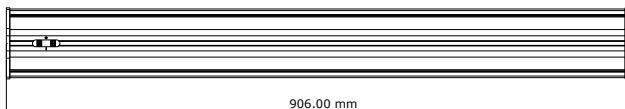

P08-Pi

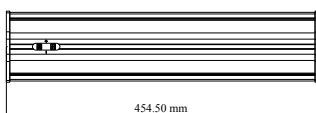

P04-Pi

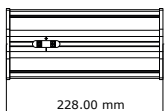

P02-Pi

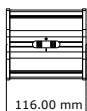

P01-Pi

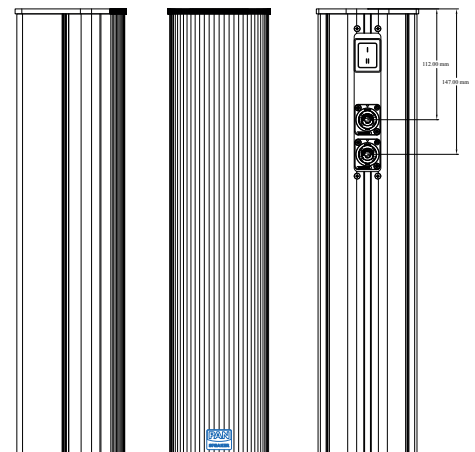
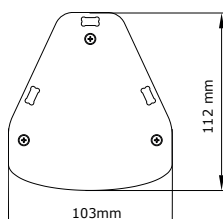

MADE IN GERMANY - All products are developed and manufactured by Pan Acoustics in Germany.

Pan Acoustics reserves the right to change product specification without notice.

www.pan-acoustics.de

Pan Acoustics GmbH | Lindener Str. 15 | D-38300 Wolfenbüttel | Germany | Tel.: +49 (0) 5331 900 95 70 | E-Mail: kontakt@pan-acoustics.de